

Ratio 1:1
Flow rate 30 l/min



P/N OE33360

P/N OE33396

S/STEEL AISI 304 PUMPS FOR TRANSFER ANTIFREEZE LIQUID, WINDSHIELD WASHING LIQUID S. 600

| P/N | OE33360 | OE33396 |
|-------------------------------|---|---------------------------|
| Seals | VITON | |
| Compatible fluids | Suitable for antifreeze and windshield washing liquid | |
| Suction tube upper body | Stainless steel AISI 304 | |
| Suction tube | Stainless steel AISI 304 | |
| Air inlet connection | F1/4"G | F1/4"G |
| Fluid outlet connection | F1/2"G | F1/2"G |
| Air working pressure | bar | 6 - 8 |
| Average air consumption | l/min | 370 |
| Noise level | dB | 81 |
| Max deliverable oil viscosity | SAE | 50 |
| Bung adaptor | - | OE33434 |
| Suitable for drums or tank | modular | for drums 180 - 220 Kg |
| Packing | No. - m ³ | 1 - 0,10 |
| Weight | Kg | 5,3 |
| Dimensions (A x B x C) | mm | 410 - 0 - 0 |

PUMP AIR FEEDING PRESSURE
A 8 bar (116 psi)
B 6 bar (87 psi)
C 4 bar (58 psi)

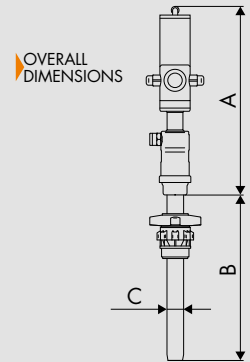
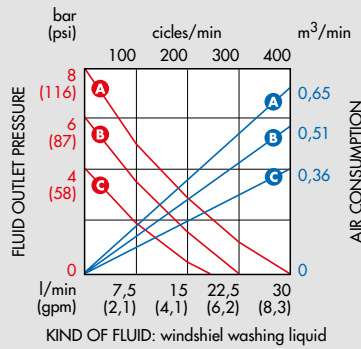

Ratio 1:1
Flow rate 30 l/min



P/N OE33300

S/STEEL AISI 304 MODULAR PUMPS FOR TRANSFER ANTIFREEZE LIQUID, WINDSHIELD WASHING LIQUID S. 600

| P/N | OE33300 | OE33301 |
|-------------------------------|---|--------------------|
| Seals | VITON | |
| Compatible fluids | Suitable for antifreeze and windshield washing liquid | |
| Suction tube upper body | Stainless steel AISI 304 | |
| Suction tube | Stainless steel AISI 304 | |
| Air inlet connection | F1/4"G | F1/4"G |
| Fluid outlet connection | F1/2"G | F1/2"G |
| Air working pressure | bar | 6 - 8 |
| Average air consumption | l/min | 370 |
| Noise level | dB | 81 |
| Max deliverable oil viscosity | SAE | 50 |
| Bung adaptor | OE33434 | OE33434 |
| Suitable for drums or tank | for drums 200 L | for tank 1000 L |
| Packing | No. - m ³ | 1 - 0,29 |
| Weight | Kg | 11,4 |
| Dimensions (A x B x C) | mm | 410 - 940 - 34 |

PUMP AIR FEEDING PRESSURE
A 8 bar (116 psi)
B 6 bar (87 psi)
C 4 bar (58 psi)

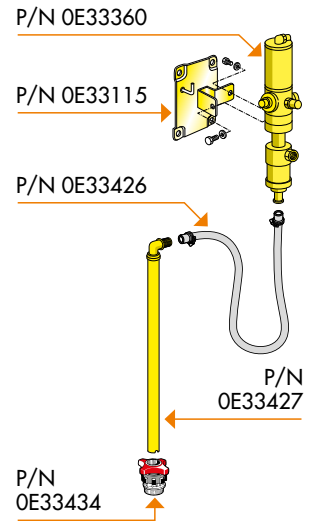
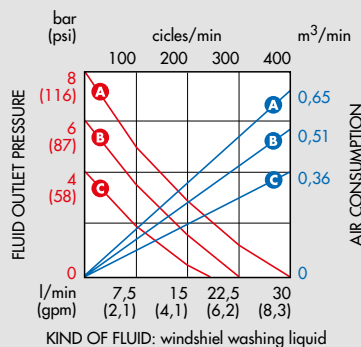

P/N OE33445
 Antifreeze and windshield liquid gun in alluminium S. 1/2" 40AN with "Viton" seals

